

How to Change Blades for COFA 4 and 5 Tools

Step 1:
Insert the Assembly pin's end into the side hole to remove the split pin.

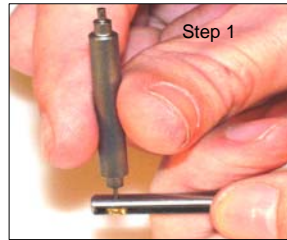

Step 2:
Use a small hammer to press the split pin out of the tool body. The blade will fall out of the tool.



NOTE:
HEULE recommends that you use a new split pin with each blade change and dispose of the old pin.

Step 3:
Insert the blade in the tool body in the direction of the illustration marked on the tool body.



Step 4:
Line up the blade hole and tool body bore using the assembly pin given with each tool. Using a hammer or mallet, insert the split pin from the opposite side as shown.

